



Zimmer® M/L Taper Hip Prosthesis

Abbreviated
Surgical Technique



Bone Conserving, Simple Technique

1 Resect Femoral Head

Place the Osteotomy Guide in the desired position on the femur and resect the femoral head.

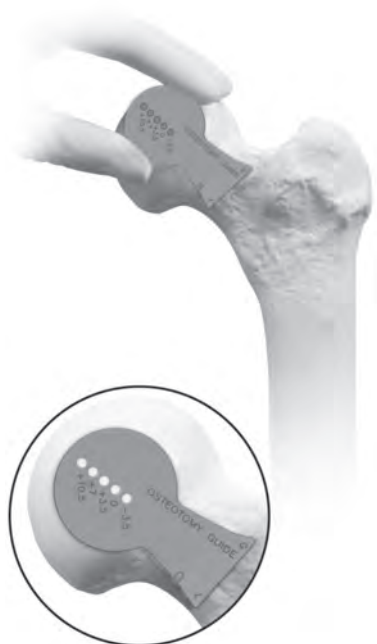

2 Remove Medial Trochanteric Bone

Use the Box Osteotome to remove the medial portion of the greater trochanter and lateral femoral neck.



3 Open Medullary Canal

Use the Starter Awl or Starter Rasp to open the medullary canal.



4 Rasp Femur

Begin the rasping sequence with an M/L Taper System Rasp that is at least two sizes smaller than the estimated implant size.



5 Plane Calcar (Optional)

Insert the tip of the guide rod on the Calcar Planer into the hole on top of rasp. Start the drill/driver and advance the planer into the bone slowly while rotating the planer around the guide rod.



6 Perform Trial Reduction

Assemble the appropriately sized Standard or Extended Cone Provisional and Femoral Head Provisional to the rasp and perform a trial reduction.

Note: Verify etched size on rasp and provisionals before performing a trial reduction.



7 Insert Femoral Stem Implant

Insert the implant by hand and use the Standard Stem Driver to impact the implant. The Standard Stem Driver has a teardrop-shaped tip to allow the surgeon to control rotation during insertion.



7A Optional Insertion Technique

Attach the Stem Inserter to the selected femoral implant and insert the implant until it will no longer advance with hand pressure. Begin to tap the Stem Inserter handle with mallet until prosthesis is fully seated. A third option, Round Tip Stem Driver allows rotational freedom during insertion.



8 Attach Femoral Head Implant

Check to ensure that the 12/14 taper is clean and dry. Then place the selected femoral head on the taper and secure it firmly by twisting it and striking it once with the Head Impactor.



Zimmer M/L Taper Hip Prosthesis

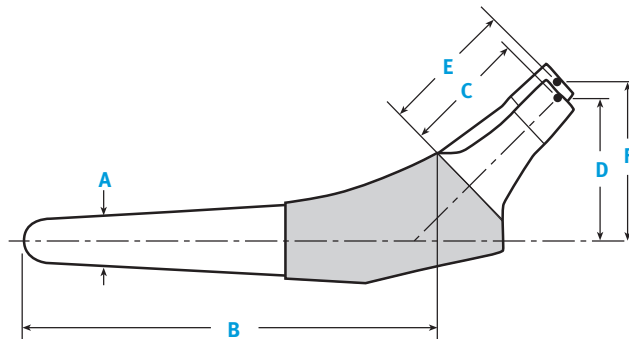

Standard Offset

| Prod. No. | HA/TCP Prod. No. | A Stem Size (mm) | B Stem Length (mm) | C Neck Length (mm) When Head/Neck Component Selected is: | | | | | D Stem Offset (mm) When Head/Neck Component Selected is: | | | | |
|----------------|------------------|------------------|--------------------|--|----|------|----|-------|--|----|------|----|-------|
| | | | | -3.5 | +0 | +3.5 | +7 | +10.5 | -3.5 | +0 | +3.5 | +7 | +10.5 |
| 00-7711-004-10 | 65-7711-004-10 | 4 | 107 | 28 | 32 | 35 | 39 | 42 | 33 | 35 | 38 | 40 | 43 |
| 00-7711-005-00 | 65-7711-005-00 | 5 | 109 | 33 | 37 | 40 | 44 | 47 | 37 | 40 | 42 | 45 | 48 |
| 00-7711-006-00 | 65-7711-006-00 | 6 | 111 | 33 | 37 | 40 | 44 | 47 | 38 | 40 | 43 | 46 | 48 |
| 00-7711-007-00 | 65-7711-007-00 | 7.5 | 114 | 35 | 38 | 42 | 45 | 49 | 40 | 43 | 45 | 48 | 50 |
| 00-7711-009-00 | 65-7711-009-00 | 9 | 117 | 35 | 38 | 42 | 45 | 49 | 41 | 43 | 46 | 49 | 51 |
| 00-7711-010-00 | 65-7711-010-00 | 10 | 119 | 35 | 38 | 42 | 45 | 49 | 41 | 44 | 46 | 49 | 52 |
| 00-7711-011-00 | 65-7711-011-00 | 11 | 121 | 35 | 38 | 42 | 45 | 49 | 42 | 44 | 47 | 50 | 52 |
| 00-7711-012-00 | 65-7711-012-00 | 12.5 | 124 | 35 | 38 | 42 | 45 | 49 | 42 | 45 | 48 | 50 | 53 |
| 00-7711-013-00 | 65-7711-013-00 | 13.5 | 126 | 35 | 38 | 42 | 45 | 49 | 43 | 46 | 48 | 51 | 53 |
| 00-7711-015-00 | 65-7711-015-00 | 15 | 129 | 35 | 38 | 42 | 45 | 49 | 44 | 46 | 49 | 52 | 54 |
| 00-7711-016-00 | 65-7711-016-00 | 16.25 | 132 | 35 | 39 | 42 | 46 | 49 | 44 | 47 | 49 | 52 | 54 |
| 00-7711-017-00 | 65-7711-017-00 | 17.5 | 134 | 35 | 38 | 42 | 45 | 49 | 45 | 48 | 50 | 53 | 55 |
| 00-7711-020-00 | 65-7711-020-00 | 20 | 139 | 35 | 38 | 42 | 45 | 49 | 46 | 49 | 51 | 54 | 57 |
| 00-7711-022-00 | 65-7711-022-00 | 22.5 | 144 | 35 | 38 | 42 | 46 | 49 | 47 | 50 | 53 | 55 | 58 |

Extended Offset

| Prod. No. | HA/TCP Prod. No. | A Stem Size (mm) | B Stem Length (mm) | E Neck Length (mm) When Head/Neck Component Selected is: | | | | | F Stem Offset (mm) When Head/Neck Component Selected is: | | | | |
|----------------|------------------|------------------|--------------------|--|----|------|----|-------|--|----|------|----|-------|
| | | | | -3.5 | +0 | +3.5 | +7 | +10.5 | -3.5 | +0 | +3.5 | +7 | +10.5 |
| 00-7711-004-40 | 65-7711-004-40 | 4 | 107 | 32 | 35 | 39 | 42 | 46 | 38 | 40 | 43 | 45 | 48 |
| 00-7711-005-20 | 65-7711-005-20 | 5 | 109 | 37 | 40 | 44 | 47 | 51 | 42 | 45 | 47 | 50 | 53 |
| 00-7711-006-20 | 65-7711-006-20 | 6 | 111 | 37 | 40 | 44 | 47 | 51 | 43 | 45 | 48 | 51 | 53 |
| 00-7711-007-20 | 65-7711-007-20 | 7.5 | 114 | 39 | 42 | 46 | 49 | 52 | 45 | 48 | 50 | 53 | 55 |
| 00-7711-009-20 | 65-7711-009-20 | 9 | 117 | 39 | 42 | 46 | 49 | 52 | 46 | 48 | 51 | 54 | 56 |
| 00-7711-010-20 | 65-7711-010-20 | 10 | 119 | 39 | 42 | 46 | 49 | 52 | 46 | 49 | 51 | 54 | 57 |
| 00-7711-011-20 | 65-7711-011-20 | 11 | 121 | 39 | 42 | 46 | 49 | 53 | 47 | 49 | 52 | 55 | 57 |
| 00-7711-012-20 | 65-7711-012-20 | 12.5 | 124 | 39 | 42 | 46 | 49 | 52 | 47 | 50 | 53 | 55 | 58 |
| 00-7711-013-20 | 65-7711-013-20 | 13.5 | 126 | 39 | 42 | 46 | 49 | 52 | 48 | 51 | 53 | 56 | 58 |
| 00-7711-015-20 | 65-7711-015-20 | 15 | 129 | 39 | 42 | 46 | 49 | 53 | 49 | 51 | 54 | 57 | 59 |
| 00-7711-016-20 | 65-7711-016-20 | 16.25 | 132 | 39 | 42 | 46 | 49 | 53 | 49 | 52 | 54 | 57 | 59 |
| 00-7711-017-20 | 65-7711-017-20 | 17.5 | 134 | 39 | 42 | 46 | 49 | 52 | 50 | 53 | 55 | 58 | 60 |
| 00-7711-020-20 | 65-7711-020-20 | 20 | 139 | 39 | 42 | 46 | 49 | 52 | 51 | 54 | 56 | 59 | 62 |
| 00-7711-022-20 | 65-7711-022-20 | 22.5 | 144 | 39 | 42 | 46 | 49 | 53 | 52 | 55 | 58 | 60 | 63 |

Please refer to package insert for complete product information, including contraindications, warnings, precautions, and adverse effects.



Contact your Zimmer representative or visit us at www.zimmer.com



+H124977711003001/\$081217R1L08+

97-7711-003-00 Rev.1 1ML Printed in USA ©2003, 2008 Zimmer, Inc.